

SHAKER CABINETS ASSEMBLY GUIDE

AUGUST 2024

TABLE OF CONTENTS

ABOUT US	○	PAGE 2
BASE CABINETS	○	PAGE 3
STANDARD BASES	●	PAGE 3
DRAWER BASES	●	PAGE 9
LAZY SUZAN CORNER	●	PAGE 15
DIAGONAL SINK BASE	●	PAGE 23
WALL CABINETS	○	PAGE 27
STANDARD UPPERS	●	PAGE 27
WALL DIAGONAL CORNER	●	PAGE 31
WALL PIE CORNER	●	PAGE 35
TALL CABINETS	○	PAGE 41
PANTRIES	●	PAGE 41
OVEN CABINETS	●	PAGE 45





ABOUT US

We are a cabinet factory-direct wholesale company that has been in business for over 10 years. Our cabinets are created with quality as our top priority. At Pioneer Cabinetry, our team is dedicated to providing great customer service to the greater Seattle area and to our customers across the nation. We have stocked several cabinet lines to suit the style, shape, and size requirements of every customer.

Our Seattle warehouse stocks over 70,000sqft of cabinetry for quick distribution both locally and nationally. With an experienced team of staff, we ensure seamless project completion for all our customers.

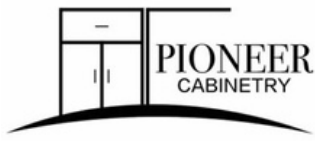

STANDARD BASE CABINETS

Assembly Tools & Materials Required:

- Air compressor
- Air hose
- Brad nail gun
- 1/4" inch brad nails
- Drill
- Rubber mallet
- Utility knife
- Wood glue (optional)

Assembly techniques used are applicable to:

- B12, B15, B18, B21, B24, B27, B30, B33, B36, B39, B42, BBC45
- B09, SB24, SB27, SB30, SB33, SB36, SB42, FSB36, BBC39, BBC42, VSB24, VSB27, VSB30, VSB36 (no drawer assembly applicable)
- BMC30 (no doors attachment applicable & additional middle panel)
- VSD30L, VSD30R, VSD36L, VSD36R, VSD42L VSD42R, VSD48, VSD54, VSD60-6D, & VSD60-3D (additional doors and/or drawers)

Instructions: Cabinet Box Assembly

1. On a flat, smooth work surface lay the face frame down, dado groove side up, and apply a thin strip of wood glue in each pre-cut dado groove of the cabinet frame (optional).

2. Before the glue dries, slide the side panels into the dado grooves of the frame, pushing upwards to evenly distribute the wood glue. Make sure that both side panels has all pre-cut dado grooves facing inwards towards each other with the smooth finished sides of the side panels facing outwards.

Assembly Tip: **If the panels are not sliding into the dado grooves smoothly, you can use a utility knife to carefully trim down the butt cut end on the panels and the dado groove on the frame if there's any unevenness**

3. Secure the side panels to the face frame using the provided metal L brackets following the pre-drilled bracket holes at the top and bottom of the frame (4 brackets total with 2 brackets to the top - L & R sides where the side panel meets the frame and 2 brackets at the bottom - L & R sides where the side panel meets the frame).

4. Next, put in the bottom panel by sliding it down along the dado grooves of the two side panels and face frame. Ensure that the bottom panel piece is sitting completely flush and flat into the grooves before proceeding into the next step.



5. From the drawer slides box, remove the 2 plastic, L-shaped back side, slide clips and insert them into the pre-drilled holes in center edges of the back panel piece. Ensure that the clips are put in the correct direction, with the long edge of the clip facing the bottom edge of the back panel which has a dado groove running along the edge, before securing the clips to the panel with screws (4 screws total - 2 screws per plastic clip, on the L & R sides of the plastic clip, center part of the clip can slide over L & R).

STANDARD BASE CABINETS

Instructions: Cabinet Box Assembly cont.

6. Place the back panel piece down, fitting into the pre-cut channels of the side panels, making sure that the panels are all flush and sitting flat before securing the side panels to the back panel with brad nails.
7. Secure the bottom panel to the back panel with screws, using the pre-drilled holes at the bottom of the back panel as a guide.
8. Screw on the top 4 wooden corner anchoring brackets to secure the final shape of the cabinet box.
9. Finally, complete your cabinet box by placing the toe kick board at the bottom indented edge and screw or nail in place with brad nails.

Instructions: Drawer Box Assembly

Drawer Box Assembly Parts List For Each Drawer Box

- 1 x drawer face & drawer box front panel (screwed together)
- 1 x drawer box back panel
- 2 x drawer box side panels
- 1 x drawer box bottom panel
- 2 x drawer slides

10. Align one of the drawer box side panel's dovetail cuts to the drawer box front panel's dovetail cuts and hammer in place using a rubber mallet. Make sure that the correct sides are joined together so that all of the rounded edges match up leaving a flat, flush side. Repeat the same process for the second drawer box side panel and brad nail to further secure the dovetail joints.

11. Next, slide in the drawer box's bottom panel along the grooves of the side panels, making sure that the smooth side of the panel faces up, before hammering on the drawer box's back panel in place following the dovetail cuts on the other end of the side panels and securing the dovetail joints with brad nails.



12. Flip the completed drawer box so that the bottom panel is facing up. Grab the pair of plastic drawer clips from the drawer slides box and place them in the front corners of the bottom panel closest to the drawer face side. Make sure that the white pieces are facing inwards, towards each other, before screwing the clips in place to secure. These clips will help to secure the drawer box on to the slides during the drawer installation.



STANDARD BASE CABINETS

Instructions: Drawer Attachment

13. Grabbing a metal drawer slide, align and slide it into one of the grey drawer clips attached to the cabinet box's back panel, making sure that the pre-drilled screw marking holes are aligned to the frame of the cabinet before screwing in place at the frame area. Repeat for the remaining drawer slide.



14. Once both slides have been secured to the drawer box, pull out both slides and place on the drawer box, make sure to fit the drawer box's back notches to the slides first. Pull the slides all the way up to the drawer clips until you hear a "click" sound confirming that the slides are secured to the clips.



15. If you wish to remove the drawer box later, simply press the two white pieces on the drawer clips and the drawer box can be lifted off and removed from the slide rails.



Instructions: Door Attachment

16. With the cabinet door faced down (pre-drilled hinge holes facing upwards), flip open the door hinges and place the rounded side of the hinge into the pre-drilled hinge holes in the door, securing in place with the short, rounded head screw - make sure to double check the screw length before securing to ensure that it will not show through the other side of the door.

17. Align the flat side of the door hinges to the cabinet frame's pre-drilled hinge pin holes and screw in place. For finishing touches, stick on the rubber door & drawer stoppers to the outer corners at the back of the door and drawer face & add in shelf pins and shelves to complete.

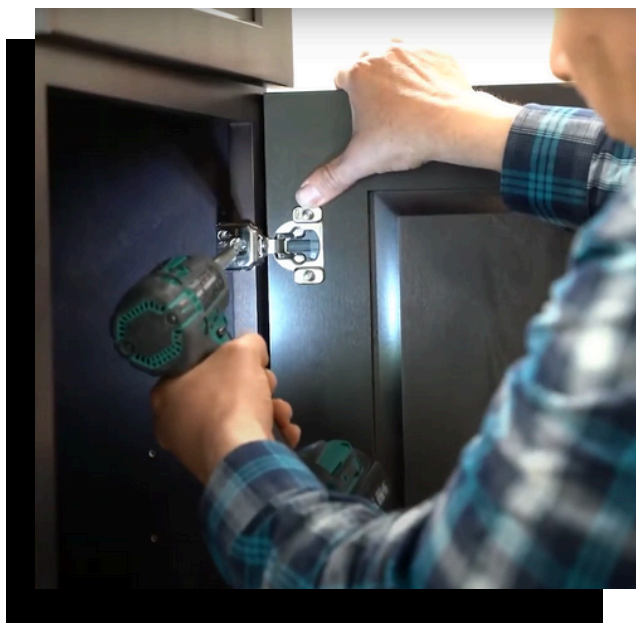

Door Adjustment Tip: *If you notice a gap or miss alignment after screwing on the door, you can re-adjust the screws using a screwdriver in order to level and align your door. Be sure that a screwdriver, and not a drill, is used for adjustments since the hinge hardware is really delicate. The front screws adjust the door left and right, and the two side screws adjust the door to move up and down, and inward or outward.***

DRAWER BASE CABINETS

Assembly Tools & Materials Required:

- Air compressor
- Air hose
- Brad nail gun
- 1/4" inch brad nails
- Drill
- Rubber mallet
- Utility knife
- Wood glue (optional)

Assembly techniques used are applicable to:

- DB12, DB15, DB18, DB21, DB24, DB27, DB30, DB33, DB36
- VDB12, VDB15, VDB18, VDB21, VDB24

Instructions: Cabinet Box Assembly

1. On a flat, smooth work surface lay the face frame down, dado groove side up, and apply a thin strip of wood glue in each pre-cut dado groove of the cabinet frame (optional).

Assembly Tip: *If the panels are not sliding into the dado grooves smoothly, you can use a utility knife to carefully trim down the butt cut end on the panels and the dado groove on the frame if there's any unevenness*****

2. Before the glue dries, slide the side panels into the dado grooves of the frame, pushing upwards to evenly distribute the wood glue. Make sure that both side panels has all pre-cut dado grooves facing inwards towards each other with the smooth finished sides of the side panels facing outwards.

3. Secure the side panels to the face frame using the provided metal L brackets following the pre-drilled bracket holes at the top and bottom of the frame (4 brackets total with 2 brackets to the top - L & R sides where the side panel meets the frame and 2 brackets at the bottom - L & R sides where the side panel meets the frame).

4. Next, put in the bottom panel by sliding it down along the dado grooves of the two side panels and face frame. Ensure that the bottom panel piece is sitting completely flush and flat into the grooves before proceeding into the next step.



5. From the drawer slides box, remove the 2 plastic, L-shaped back side, slide clips and insert them into the pre-drilled holes in center edges of the back panel piece. Ensure that the clips are put in the correct direction, with the long edge of the clip facing the bottom edge of the back panel which has a dado groove running along the edge, before securing the clips to the panel with screws (4 screws total - 2 screws per plastic clip, on the L & R sides of the plastic clip, center part of the clip can slide over L & R). Repeat for the remaining two sets of drawer slides.



6. Place the back panel piece down, fitting into the pre-cut channels of the side panels, making sure that the panels are all flush and sitting flat before securing the side panels to the back panel with brad nails.



DRAWER BASE CABINETS

Instructions: Cabinet Box Assembly cont.

7. Secure the bottom panel to the back panel with screws, using the pre-drilled holes at the bottom of the back panel as a guide.
8. Screw on the top 4 wooden corner anchoring brackets to secure the final shape of the cabinet box.
9. Finally, complete your cabinet box by placing the toe kick board at the bottom indented edge and screw or nail in place with brad nails.

Instructions: Drawer Box Assembly

Drawer Box Assembly Parts List For Each Drawer Box

- 1 x drawer face & drawer box front panel (screwed together)
- 1 x drawer box back panel
- 2 x drawer box side panels
- 1 x drawer box bottom panel
- 2 x drawer slides

10. Align one of the drawer box side panel's dovetail cuts to the drawer box front panel's dovetail cuts and hammer in place using a rubber mallet. Make sure that the correct sides are joined together so that all of the rounded edges match up leaving a flat, flush side. Repeat the same process for the second drawer box side panel and brad nail to further secure the dovetail joints.

11. Next, slide in the drawer box's bottom panel along the grooves of the side panels, making sure that the smooth side of the panel faces up, before hammering on the drawer box's back panel in place following the dovetail cuts on the other end of the side panels and securing the dovetail joints with brad nails. Repeat steps 10 - 11 to build the other two drawer boxes.



12. Flip the completed drawer box so that the bottom panel is facing up. Grab the pair of plastic drawer clips from the drawer slides box and place them in the front corners of the bottom panel closest to the drawer face side. Make sure that the white pieces are facing inwards, towards each other, before screwing the clips in place to secure. These clips will help to secure the drawer box on to the slides during the drawer installation.



DRAWER BASE CABINETS

Instructions: Drawer Attachment

13. Grabbing a metal drawer slide, align and slide it into one of the grey drawer clips attached to the cabinet box's back panel, making sure that the pre-drilled screw marking holes are aligned to the frame of the cabinet before screwing in place at the frame area. Repeat for the remaining drawer slides.



14. Once both slides have been secured to the drawer box, pull out both slides and place on the drawer box, make sure to fit the drawer box's back notches to the slides first. Pull the slides all the way up to the drawer clips until you hear a “click” sound confirming that the slides are secured to the clips. Repeat for the last 2 drawer boxes.



15. If you wish to remove the drawer box later, simply press the two white pieces on the drawer clips and the drawer box can be lifted off and removed from the slide rails.

16. For finishing touches, stick on the included rubber drawer stoppers to the four outer corners at the back of the drawer faces to complete.



BASE LAZY SUSAN CORNER

Assembly Tools & Materials Required:

- Air compressor
- Air hose
- Brad nail gun
- 1/4" inch brad nails
- Drill
- Rubber mallet
- Utility knife
- Wood glue (optional)

Assembly techniques used are applicable to:

- BLS33 & BLS36

Instructions: Revolving Shelf Assembly



1. Take out the two revolving shelves from the separately packed “LSK” box. Taking one of the revolving shelves, flip it upside-down and turn the attached plywood piece of hardware until you hear a “click” sound indicating that the revolving shelf is set to the correct position with the protruding metal panel pointed towards the 90 degree corner.

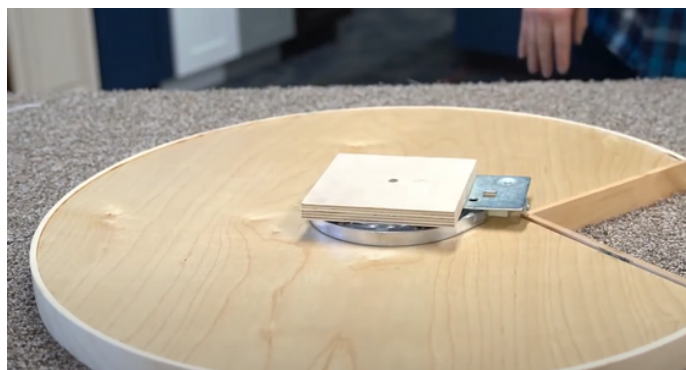



*****Be sure to check that the shelf spins in both directions (clockwise and counter-clockwise) and that the shelf locks at the correct position before proceeding onwards*****

2. Align the holes of the base shelf board and the revolving shelf together until both pre-drilled holes are perfectly matched before nailing the two pieces together in place with brad nails. Make sure that the nails are placed around 1 to 2 inches away from the center hole. Once finished, spin the tray around and lift it up to double check that both pieces are attached together securely. Repeat the same directions for the other revolving shelf.

Frame Assembly List of Items:

- 2 x U-shaped frame pieces (one longer & one shorter)
- 2 x frame front side panels (has 2 wooden blocks attached to each panel)
- Metal L brackets & screws included

Instructions: Cabinet Box Assembly

3. On a flat, smooth work surface lay the face frame down, dado groove side up, and apply a thin strip of wood glue in each pre-cut dado groove of the cabinet frame (optional).

BASE LAZY SUSAN CORNER

Instructions: Cabinet Box Assembly cont.

4. Next, slide the front side panel into the groove of the frame, pushing upwards to evenly distribute the glue. Ensure that the side panel piece is paired with the correct frame piece by checking if the bottom grooves line up.



5. Further secure the side panel to the frame using the provided metal L brackets, placing one at the top and one at the bottom of the frame. Repeat steps 3 - 5 for the other frame and front side panel piece. Making sure to that the grooves of the two pieces line up to each other before securing in place.



6. Next, connect the frame pieces together by aligning the pre-drilled holes at the top and bottom of the two frames, and screwing the two pieces together using a long screw from the included hardware box.



7. Place in one of the revolving shelves in the bottom grooves of the front side panels & frame part and secure in place using metal L brackets at the bottom of where the shelf panel meets the frame and side panels. Be sure to place 2 brackets connecting the frame to the shelf and 2 brackets connecting the side panel to the shelf to ensure secure placement.



BASE LAZY SUSAN CORNER

Instructions: Cabinet Box Assembly cont.

8. For the second revolving shelf, place it in along the center grooves of the side panels and snap in place. No additional L brackets should be needed to secure this shelf.

9. For the next step, grab the remaining two rear side panel pieces, the ones with 3 grooves, and slide it into place. Secure the rear side panel pieces to the rest of the cabinet using the long screws from the hardware box, following the pre-drilled holes as a guide. Repeat the same steps for the other rear side panel piece and complete the cabinet box by putting in the back panel piece and screwing it in place.



10. Use the included 135 degree metal bracket pieces to further secure the back panel piece to the rear side panels from the inside of the cabinet box.



11. Further secure the corners of the cabinet frame by screwing on wooden brackets at each 90 degree corner.

12. Further secure the back panel by screwing on the included, beveled plywood inserts along the pre-drilled holes.

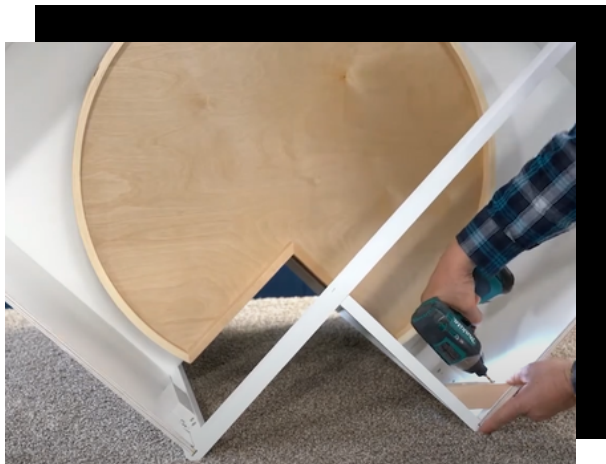

13. Next, connect the toe kick pieces together, making sure that the cut out edges are facing up before screwing in place. Secure the toe kick piece to the cabinet using a brad nails.



BASE LAZY SUSAN CORNER

Instructions: Door Attachment

14. Place the hinge in the door's pre-drilled hinge holes and secure in place with a screw. Be sure to double check that the screw's length isn't too long to prevent damaging the door. Repeat the same steps for the other door hinge.



15. Flip down and expand out the hinges attached to the door before aligning the hinge to the holes on the cabinet frame's wood blocks and screwing it on. If you wish for the door to open to the left, attach the hinge to the left side blocks. For it to open to the right, attach to the right side blocks.

16. Finally, we will work on putting in the magnet piece which will keep the door tightly closed. First, screw on the white plastic piece of magnet on the door frame opposite of the door.





17. Next, stick the thin metal piece with a screw through one of the holes onto the magnetic white piece on the frame. Press the door lightly into the screw to create an indent on the door to map out where to screw in the metal bit. Before screwing on, double check that the screw length isn't too long, so that it won't run through the door.



18. Repeat steps 16 - 17 for the bottom magnet pieces. Finish by adding on rubber door stoppers to the outer back corners of the door.



DIAGONAL SINK BASE

Assembly Tools & Materials Required:

- Air compressor
- Air hose
- Brad nail gun
- 1/4" inch brad nails
- Drill
- Rubber mallet
- Utility knife
- Wood glue (optional)

Assembly techniques used are applicable to:

- SBD36 & SBD45

Instructions: Cabinet Box Assembly

1. On a flat, smooth work surface lay the face frame down, dado groove side up, and apply a thin strip of wood glue in each pre-cut dado groove of the cabinet frame (optional).

2. Before the glue dries, slide the front side panels into the dado grooves of the frame, pushing upwards to evenly distribute the wood glue. Make sure that both side panels has all pre-cut dado grooves facing inwards towards each other with the smooth finished sides of the side panels facing outwards. Secure the two pieces together using a 135 degree metal bracket, placing one bracket at the top and one at the bottom of the frame. Repeat the same steps to attach the other front side panel.

Assembly Tip: **If the panels are not sliding into the dado grooves smoothly, you can use a utility knife to carefully trim down the butt cut end on the panels and the dado groove on the frame if there's any unevenness**

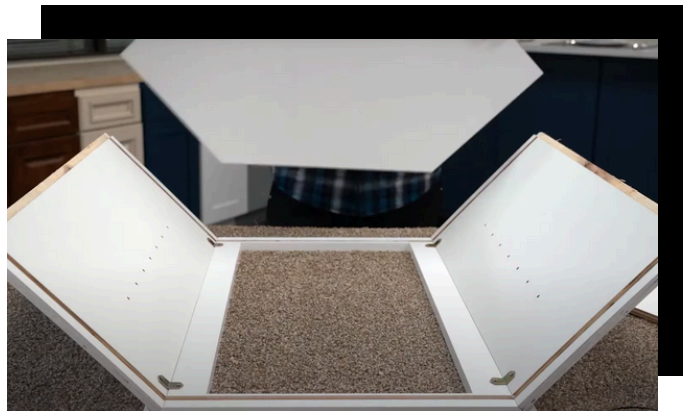

3. Next, place in the bottom panels following the groove lines.



4. Place in one of the remaining rear side panel pieces and screw it in place, using the pre-drilled holes as a guide. Repeat the same for the other rear side panel.



DIAGONAL SINK BASE

Instructions: Cabinet Box Assembly cont.

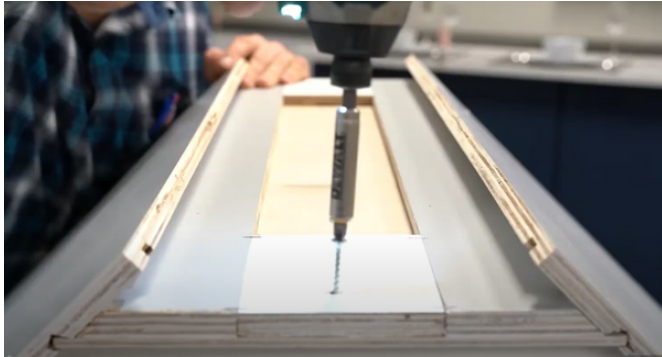

5. Next, place on the back panel piece. Make sure that all the panel pieces are fitted to each other's grooves before securing the pieces together with screws, using the pre-drilled holes as a guide. Reinforce the back panel by screwing on the two included plywood inserts.

6. Screw on the top wooden corner anchoring brackets to secure the final shape of the cabinet box.

7. Finally, complete your cabinet box by placing the toe kick board at the bottom indented edge and screw or nail in place with brad nails.



Instructions: Door Attachment



8. Place the hinge into the pre-drilled hinge holes and screw in place. Make sure that you are using the round-headed, short screws and not the flat-headed screws so that the screw won't run through the door. Repeat the same steps for installing the other remaining hinges



9. Align the hinge to the pre-drilled holes on the frame and screw in place.

10. For finishing touches, stick on the rubber door stoppers in the outer back corners of the door.

Door Adjustment Tip: **If you notice a gap or miss alignment after screwing on the door, you can re-adjust the screws using a screwdriver in order to level and align your door. Be sure that a screwdriver, and not a drill, is used for adjustments since the hinge hardware is really delicate. The front screws adjust the door left and right, and the two side screws adjust the door to move up and down, and inward or outward.



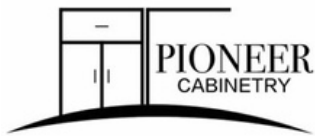

STANDARD WALL CABINETS

Assembly Tools & Materials Required:

- Air compressor
- Air hose
- Brad nail gun
- 1/4" inch brad nails
- Drill
- Rubber mallet
- Utility knife
- Wood glue (optional)

Assembly techniques used are applicable to:

- W0930, W1230, W1530, W2130, W0936, W1236, W1536, W1836, W2136, W0942, W1242, W1542, W1842, W2142 (single door)
- W1230G, W1530G, W2130G, W1236G, W1536G, W1836G, W2136G, W1242G, W1542G, W1842G, W2142G (single door)
- W2430, W2730, W3030, W3330, W3630, W3930, W4230, W2436, W2736, W3036, W3336, W3636, W3936, W4236, W2442, W2742, W3042, W3342, W3642, W3942, W4242 (double doors)
- W2430G, W2730G, W3030G, W3330G, W3630G, W2436G, W2736G, W3036G, W3336G, W3636G, W2442G, W2742G, W3042G, W3342G, W3642G (double doors)
- W2412, W2415, W2418, W2421, W2712, W2715, W2718, W3012, W3015, W3018, W3021, W3312, W3315, W3318, W3321, W3612, W3615, W3618, W3621, W31 1/2 1224, W31 1/2 1524, W31 1/2 1824, W31 1/2 2124, W36 1/2 1224, W36 1/2 1524, W36 1/2 1824, W36 1/2 2124 (double doors, no shelf)
- W3024, W3324, W3624, W31 1/2 2424, W36 1/2 2424 (double doors)

Assembly techniques used are applicable to continued:

- W2112, W2115, W2115 (single door, no shelf)
- WBC2730, WBC2736, WBC2742 (single door only)
- WM2730, WM2736, WM2742 (additional bottom shelf panel)

Instructions: Cabinet Box Assembly

1. On a flat, smooth work surface lay the face frame down, dado groove side up, and apply a thin strip of wood glue in each pre-cut dado groove of the cabinet frame (optional).



Assembly Tip: **If the panels are not sliding into the dado grooves smoothly, you can use a utility knife to carefully trim down the butt cut end on the panels and the dado groove on the frame if there's any unevenness**



2. Before the glue dries, slide the side panels into the dado grooves of the frame, pushing upwards to evenly distribute the wood glue. Make sure that both side panels has all pre-cut dado grooves facing inwards towards each other with the smooth finished sides of the side panels facing outwards.

3. Ensure that the side panel piece is paired with the correct frame piece by checking if the top and bottom grooves line up.

STANDARD WALL CABINETS

Instructions: Cabinet Box Assembly cont.



4. Secure the side panels to the face frame using the provided metal L brackets following the pre-drilled bracket holes at the top and bottom of the frame (4 brackets total with 2 brackets to the top - L & R sides where the side panel meets the frame and 2 brackets at the bottom - L & R sides where the side panel meets the frame). Repeat steps 3 - 4 for the other frame and front side panel piece. Making sure to that the grooves of the two pieces line up to each other before securing in place.

5. Next, slide in the top and bottom panels following the grooves. Place on the back panel and nail it in place to the side panels. Secure the back panel to the top and bottom panels using the provided screws.



Instructions: Door Attachment

6. Place the hinge into the pre-drilled hinge holes and screw in place. Make sure that you are using the round-headed, short screws and not the flat-headed screws so that the screw won't run through the door. Repeat the same steps for installing the other remaining hinges

7. Align the hinge to the pre-drilled holes on the cabinet frame and screw the door in place. Repeat the same steps for the other remaining hinges.



Door Adjustment Tip: **If you notice a gap or miss alignment after screwing on the door, you can re-adjust the screws using a screwdriver in order to level and align your door. Be sure that a screwdriver, and not a drill, is used for adjustments since the hinge hardware is really delicate. The front screws adjust the door left and right, and the two side screws adjust the door to move up and down, and inward or outward.

8. For finishing touches, stick on the rubber door stoppers to the outer back corners of the doors and place in the shelf pins at your desired shelf height using the pre-drilled holes as a guide. Then put in the shelf boards. With this, your wall cabinet is ready to be installed!

WALL DIAGONAL CORNER

Assembly Tools & Materials Required:

- Air compressor
- Air hose
- Brad nail gun
- 1/4" inch brad nails
- Drill
- Rubber mallet
- Utility knife
- Wood glue (optional)

Assembly techniques used are applicable to:

- WDC2430, WDC2436, WDC2442, WDC2430G, WDC2436G, WDC2442G

Instructions: Cabinet Box Assembly

1. On a flat, smooth work surface lay the face frame down, dado groove side up, and apply a thin strip of wood glue in each pre-cut dado groove of the cabinet frame (optional).

2. Before the glue dries, slide the side panels into the dado grooves of the frame, pushing upwards to evenly distribute the wood glue. Make sure that both front side panels has all pre-cut dado grooves facing inwards towards each other with the smooth finished sides of the front side panels facing outwards. Secure the two pieces together using a 135 degree metal bracket, placing one bracket at the top and one at the bottom of the frame. Repeat the same steps to attach the other front side panel.

Assembly Tip: **If the panels are not sliding into the dado grooves smoothly, you can use a utility knife to carefully trim down the butt cut end on the panels and the dado groove on the frame if there's any unevenness**

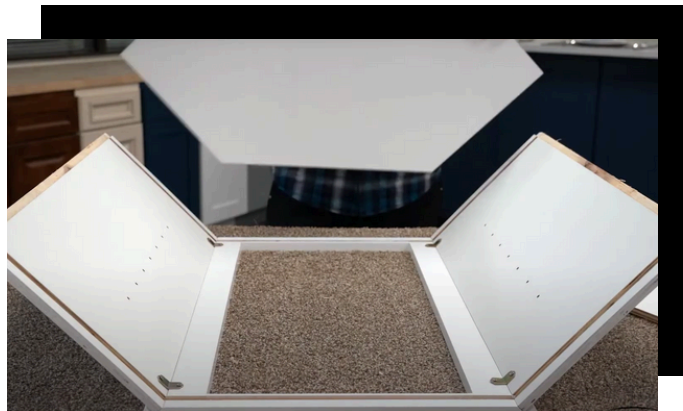

3. Next, place in the top and bottom panels following the groove lines.



4. Place in one of the remaining rear side panel pieces and screw it in place, using the pre-drilled holes as a guide. Repeat the same for the other rear side panel.



WALL DIAGONAL CORNER

Instructions: Cabinet Box Assembly cont.

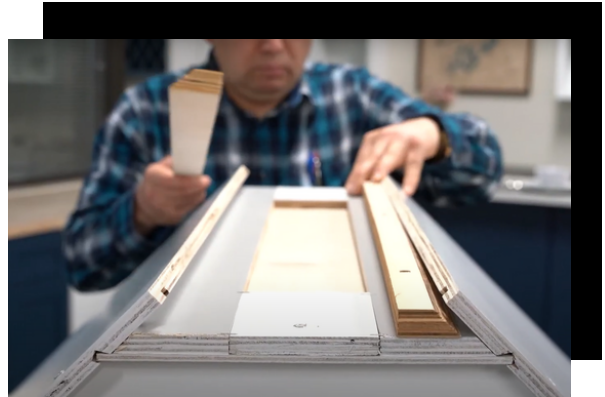
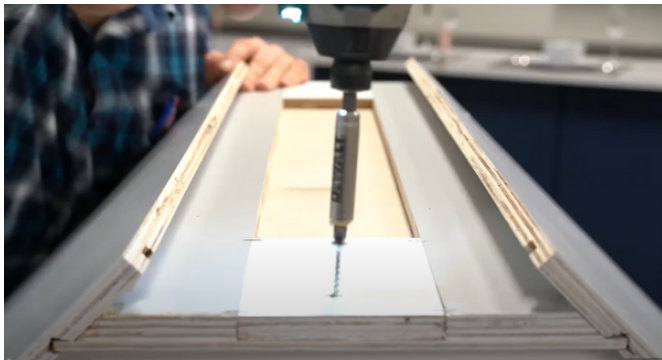

5. Next, place on the back panel piece. Make sure that all the panel pieces are fitted to each other's grooves before securing the pieces together with screws, using the pre-drilled holes as a guide. Reinforce the back panel by screwing on the two included plywood inserts.

6. Place in the shelf pins at your desired shelf height using the pre-drilled holes as a guide. Then put in the shelf boards.

Instructions: Door Attachment

7. Place the hinge into the pre-drilled hinge holes and screw in place. Make sure that you are using the round-headed, short screws and not the flat-headed screws so that the screw won't run through the door. Repeat the same steps for installing the other remaining hinges



8. Align the hinge to the pre-drilled holes on the frame and screw in place.



9. For finishing touches, stick on the rubber door stoppers in the outer back corners of the door and finally with this, your cabinet is ready to be installed!

Door Adjustment Tip: **If you notice a gap or miss alignment after screwing on the door, you can re-adjust the screws using a screwdriver in order to level and align your door. Be sure that a screwdriver, and not a drill, is used for adjustments since the hinge hardware is really delicate. The front screws adjust the door left and right, and the two side screws adjust the door to move up and down, and inward or outward.



WALL PIE CORNER

Assembly Tools & Materials Required:

- Air compressor
- Air hose
- Brad nail gun
- 1/4" inch brad nails
- Drill
- Rubber mallet
- Utility knife
- Wood glue (optional)

Assembly techniques used are applicable to:

- WPC2430, WPC2436, WPC2442

Instructions: Cabinet Box Assembly

1. On a flat, smooth work surface lay the face frame down, dado groove side up, and apply a thin strip of wood glue in each pre-cut dado groove of the cabinet frame (optional).

Assembly Tip: **If the panels are not sliding into the dado grooves smoothly, you can use a utility knife to carefully trim down the butt cut end on the panels and the dado groove on the frame if there's any unevenness**

2. Next, slide the front side panels into the groove of the frame, pushing upwards to evenly distribute the glue. Ensure that the front side panel piece is paired with the correct frame piece by checking if the top and bottom grooves line up.

Frame Assembly List of Items:

- 2 x U-shaped frame pieces (one longer & one shorter)
- 2 x frame front side panels (has 2 wooden blocks attached to each panel)
- Metal L brackets & screws included



3. Further secure the side panel to the frame using the provided metal L brackets, placing one at the top and one at the bottom of the frame. Repeat steps 2 - 3 for the other frame and front side panel piece. Making sure to that the grooves of the two pieces line up to each other before securing in place.

WALL PIE CORNER

Instructions: Cabinet Box Assembly cont.

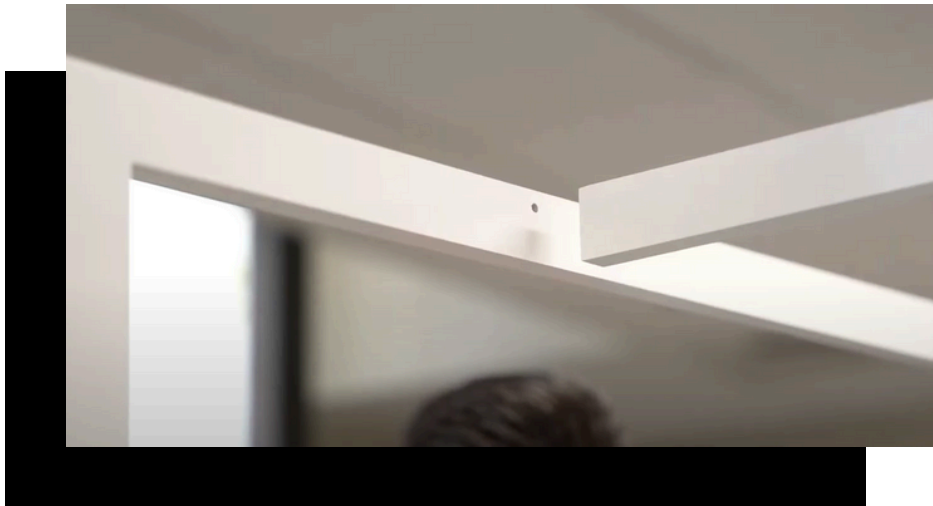

4. Next, connect the frame pieces together by aligning the pre-drilled holes at the top and bottom of the two frames, and screwing the two pieces together using a long screw from the included hardware box.

5. For the next step, grab the remaining rear side panel pieces, and slide it into place. Secure the panel pieces to the rest of the cabinet using the long screws from the hardware box, following the pre-drilled holes as a guide. Repeat the same steps for the other rear side panel piece and complete the cabinet box by putting in the back panel piece screwing the panel pieces in place.



6. Further secure the back panel by screwing on the included, beveled plywood inserts along the pre-drilled holes.



WALL PIE CORNER

Instructions: Door Attachment

7. Place the hinge in the door's pre-drilled hinge holes and secure in place with a screw. Be sure to double check that the screw's length isn't too long to prevent damaging the door. Repeat the same steps for the other door hinge.



8. Flip down and expand out the hinges attached to the door before aligning the hinge to the holes on the cabinet frame's wood blocks and screwing on to secure. If you wish for the door to open to the left, attach the hinge to the left side blocks. For it to open to the right, attach to the right side blocks.

9. Finally, we will work on putting in the magnet piece which will keep the door tightly closed. First, screw on the white plastic piece of magnet on the door frame opposite of the door.





10. Next, stick the thin metal piece with a screw through one of the holes onto the magnetic white piece on the frame. Press the door lightly into the screw to create an indent on the door to map out where to screw in the metal bit. Before screwing on, double check that the screw length isn't too long, so that it won't run through the door.



11. Repeat steps 9 - 10 for the bottom magnet pieces. Finish by adding on rubber door stoppers to the outer back corners of the door.



TALL PANTRY CABINETS

Assembly Tools & Materials Required:

- Air compressor
- Air hose
- Brad nail gun
- 1/4" inch brad nails
- Drill
- Rubber mallet
- Utility knife
- Wood glue (optional)

Assembly techniques used are applicable to:

- P1884, P1890, P1893, P1896 (single doors)
- P2484, P2490, P2493, P2496, P3084, P3090, P3093, P3096, P3684, P3690, P3693, P3696 (double doors)

Instructions: Cabinet Box Assembly

1. On a flat, smooth work surface lay the face frame down, dado groove side up, and apply a thin strip of wood glue in each pre-cut dado groove of the cabinet frame (optional).

Assembly Tip: **If the panels are not sliding into the dado grooves smoothly, you can use a utility knife to carefully trim down the butt cut end on the panels and the dado groove on the frame if there's any unevenness**

2. Before the glue dries, slide the side panels into the dado grooves of the frame, pushing upwards to evenly distribute the wood glue. Make sure that both side panels has all pre-cut dado grooves facing inwards towards each other with the smooth finished sides of the side panels facing outwards.

Instructions: Cabinet Box Assembly cont.

3. Secure the side panels to the face frame using the provided metal L brackets following the pre-drilled bracket holes at the top and bottom of the frame.
4. Next, put in the bottom panel by sliding it down along the dado grooves of the two side panels and face frame. Ensure that the bottom panel piece is sitting completely flush and flat into the grooves. Repeat the same for the middle and top panels of the pantry cabinet, fitting them flush along the grooves of the side panels and frame before proceeding to the next step.
5. Place the back panel piece down, fitting into the pre-cut channels of the side panels, making sure that the panels are all flush and sitting flat before securing the side panels to the back panel with brad nails.
6. Secure the bottom panel to the back panel with screws, using the pre-drilled holes at the bottom of the back panel as a guide. Repeat for the top and middle panels as needed.
7. Finally, complete your cabinet box by placing the toe kick board at the bottom indented edge and screw or nail in place with brad nails.

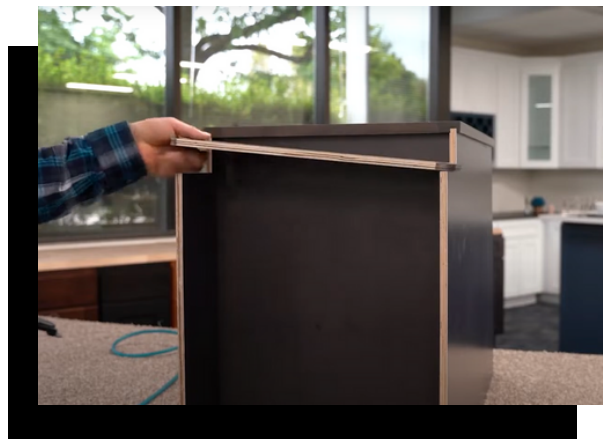

TALL PANTRY CABINETS

Instructions: Door Attachment

16. With the cabinet door faced down (pre-drilled hinge holes facing upwards), flip open the door hinges and place the rounded side of the hinge into the pre-drilled hinge holes in the door, securing in place with the short, rounded head screw - make sure to double check the screw length before securing to ensure that it will not show through the other side of the door. Repeat for all remaining hinges.

17. Align the flat side of the door hinges to the cabinet frame's pre-drilled hinge pin holes and screw in place. Repeat for all remaining doors. For finishing touches, stick on the rubber door stoppers to the outer corners at the back of the door and add in shelf pins and shelves to complete!

Door Adjustment Tip: **If you notice a gap or miss alignment after screwing on the door, you can re-adjust the screws using a screwdriver in order to level and align your door. Be sure that a screwdriver, and not a drill, is used for adjustments since the hinge hardware is really delicate. The front screws adjust the door left and right, and the two side screws adjust the door to move up and down, and inward or outward.

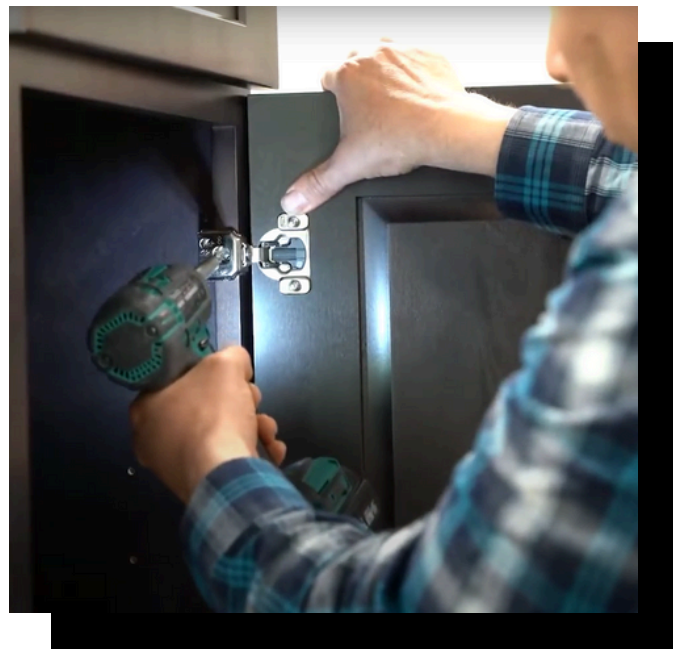



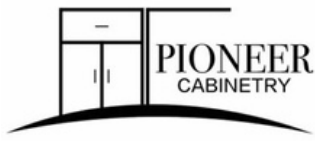

TALL OVEN CABINETS

Assembly Tools & Materials Required:

- Air compressor
- Air hose
- Brad nail gun
- 1/4" inch brad nails
- Drill
- Rubber mallet
- Utility knife
- Wood glue (optional)

Assembly techniques used are applicable to:

- OC31 1/2 84S, OC 31 1/2 90S, OC31 1/2 93S, OC31 1/2 96S (3 bottom drawers)
- OC31 1/2 84SM, OC 31 1/2 90SM, OC31 1/2 93SM, OC31 1/2 96SM (1 bottom drawer)
- OC31 1/2 84D, OC 31 1/2 90D, OC31 1/2 93D, OC31 1/2 96D (1 bottom drawer)
- OC31 1/2 84S+M/SMS, OC 31 1/2 90S+M/SMS, OC31 1/2 93S+M/SMS, OC31 1/2 96S+M/SMS (1 bottom drawer & additional middle panel)

Instructions: Cabinet Box Assembly

1. On a flat, smooth work surface lay the face frame down, dado groove side up, and apply a thin strip of wood glue in each pre-cut dado groove of the cabinet frame (optional).

2. Before the glue dries, slide the side panels into the dado grooves of the frame, pushing upwards to evenly distribute the wood glue. Make sure that both side panels has all pre-cut dado grooves facing inwards towards each other with the smooth finished sides of the side panels facing outwards.

Assembly Tip: **If the panels are not sliding into the dado grooves smoothly, you can use a utility knife to carefully trim down the butt cut end on the panels and the dado groove on the frame if there's any unevenness**

3. Secure the side panels to the face frame using the provided metal L brackets following the pre-drilled bracket holes at the top and bottom of the frame.

4. Next, put in the bottom panel by sliding it down along the dado grooves of the two side panels and face frame. Ensure that the bottom panel piece is sitting completely flush and flat to the grooves. Repeat the same for the middle and top panels of the oven cabinet, fitting them flush along the grooves of the side panels and frame before proceeding into the next step.



5. From the drawer slides box, remove the 2 plastic, L-shaped back side, slide clips and insert them into the pre-drilled holes in center edges of the back panel piece. Ensure that the clips are put in the correct direction, with the long edge of the clip facing the bottom edge of the back panel which has a dado groove running along the edge, before securing the clips to the panel with screws (4 screws total - 2 screws per plastic clip, on the L & R sides of the plastic clip, center part of the clip can slide over L & R). Repeat for any remaining slides if applicable.

TALL OVEN CABINETS

Instructions: Cabinet Box Assembly cont.

6. Place the back panel piece down, fitting into the pre-cut channels of the side panels, making sure that the panels are all flush and sitting flat before securing the side panels to the back panel with brad nails.
7. Secure the bottom panel to the back panel with screws, using the pre-drilled holes at the bottom of the back panel as a guide. Repeat for top and middle panels as needed.
9. Finally, complete your cabinet box by placing the toe kick board at the bottom indented edge and screw or nail in place with brad nails.

Instructions: Drawer Box Assembly

Drawer Box Assembly Parts List For Each Drawer Box

- 1 x drawer face & drawer box front panel (screwed together)
- 1 x drawer box back panel
- 2 x drawer box side panels
- 1 x drawer box bottom panel
- 2 x drawer slides

10. Align one of the drawer box side panel's dovetail cuts to the drawer box front panel's dovetail cuts and hammer in place using a rubber mallet. Make sure that the correct sides are joined together so that all of the rounded edges match up leaving a flat, flush side. Repeat the same process for the second drawer box side panel and brad nail to further secure the dovetail joints.

11. Next, slide in the drawer box's bottom panel along the grooves of the side panels, making sure that the smooth side of the panel faces up, before hammering on the drawer box's back panel in place following the dovetail cuts on the other end of the side panels and securing the dovetail joints with brad nails.



12. Flip the completed drawer box so that the bottom panel is facing up. Grab the pair of plastic drawer clips from the drawer slides box and place them in the front corners of the bottom panel closest to the drawer face side. Make sure that the white pieces are facing inwards, towards each other, before screwing the clips in place to secure. These clips will help to secure the drawer box on to the slides during the drawer installation.



TALL OVEN CABINETS

Instructions: Drawer Attachment

13. Grabbing a metal drawer slide, align and slide it into one of the grey drawer clips attached to the cabinet box's back panel, making sure that the pre-drilled screw marking holes are aligned to the frame of the cabinet before screwing in place at the frame area. Repeat for the remaining drawer slide(s).



14. Once both slides have been secured to the drawer box, pull out both slides and place on the drawer box, make sure to fit the drawer box's back notches to the slides first. Pull the slides all the way up to the drawer clips until you hear a "click" sound confirming that the slides are secured to the clips.

15. If you wish to remove the drawer box later, simply press the two white pieces on the drawer clips and the drawer box can be lifted off and removed from the slide rails.





17. Align the flat side of the door hinges to the cabinet frame's pre-drilled hinge pin holes and screw in place. For finishing touches, stick on the rubber door stoppers to the outer corners at the back of the door and add in shelf pins and shelves (*if applicable*) to complete.



Instructions: Door Attachment

16. With the cabinet door faced down (pre-drilled hinge holes facing upwards), flip open the door hinges and place the rounded side of the hinge into the pre-drilled hinge holes in the door, securing in place with the short, rounded head screw - make sure to double check the screw length before securing to ensure that it will not show through the other side of the door.

Door Adjustment Tip: **If you notice a gap or miss alignment after screwing on the door, you can re-adjust the screws using a screwdriver in order to level and align your door. Be sure that a screwdriver, and not a drill, is used for adjustments since the hinge hardware is really delicate. The front screws adjust the door left and right, and the two side screws adjust the door to move up and down, and inward or outward.



2020

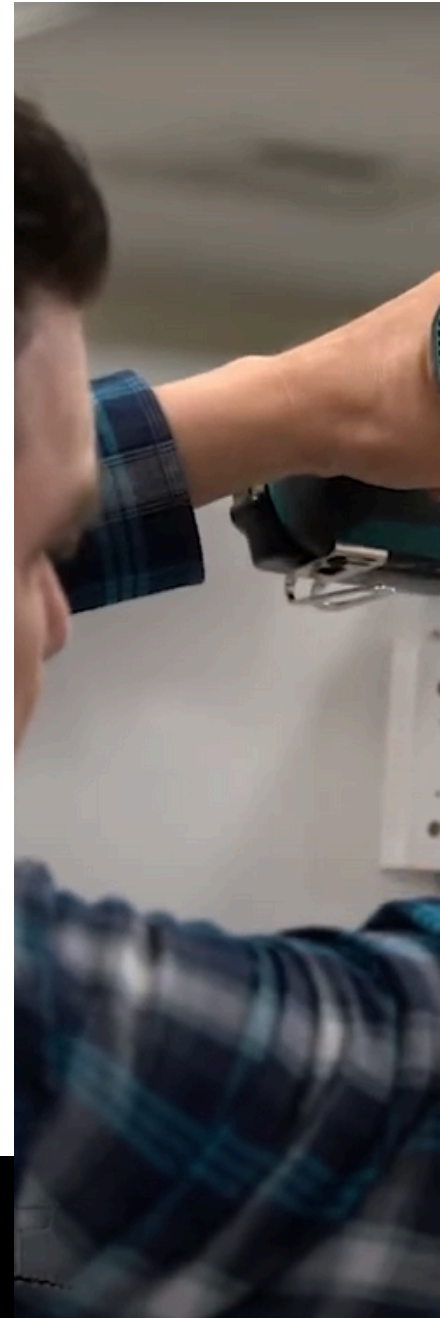

EMAIL	info@pioneercabinet.com
TEL	206 - 337 - 6886
WEB	www.pioneercabinet.com
ADDRESS	6835 S 212th St, Kent WA 98032